

AC-220 Mounting Ring Installation

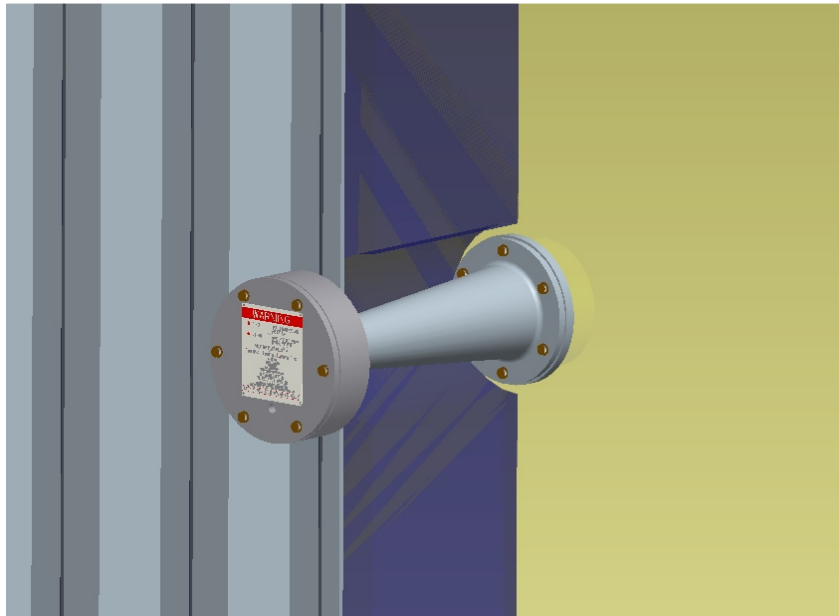

1. Cut a 3.75" diameter opening in application surface.
2. Place the mounting ring in the proper location as shown in the picture and tack weld in place. The mounting ring should be placed on the mounting surface with holes located in the 12 and 6 o'clock positions. This hole location will ensure the inlet to the horn is in the 6 o'clock position when the horn is mounted on a vertical surface.
3. Attach the horn to mounting ring with (6) 5/16-18 x 3/4" hex head cap-screws.
4. Seal weld the remainder of mounting ring to the application surface.
5. Connect the air supply from the solenoid valve to the sound generator.